

WE THANK YOU FOR
CHOOSING THIS
PRODUCT FROM
SWAROVSKI OPTIK. IF YOU
HAVE ANY QUESTIONS,
PLEASE CONSULT YOUR
SPECIALIST DEALER OR
CONTACT US DIRECTLY AT
SWAROVSKIOPTIK.COM.

SPEND ONE MINUTE. EARN ONE YEAR

Register at [SWAROVSKIOPTIK.COM](https://www.swarovskioptik.com) to enjoy all the benefits of MY ACCOUNT.

- We will extend the warranty by one year, free of charge.*
- Keep track of all your SWAROVSKI OPTIK devices and purchase dates.
- If your product requires servicing, we can quickly call up the key information and ensure that we provide fast, efficient assistance.
- You can conveniently initiate repair orders for your registered products.

*When you register a product, we will extend its warranty in line with our warranty conditions by one year (warranty card also available for download). Electronics are excluded from the extended warranty.

1. OVERVIEW

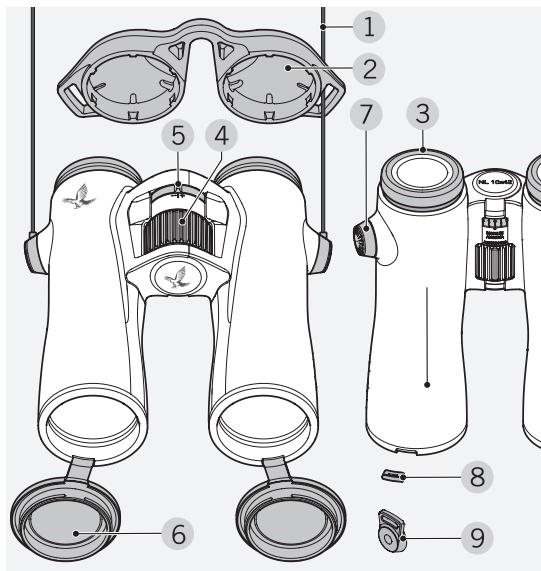

- | | |
|----------------------|-------------------------------------|
| 1 Carrying strap | 6 Objective lens cover |
| 2 Eyepiece cover | 7 Strap connector cover |
| 3 Twist-in eyecup | 8 Objective lens cover filler piece |
| 4 Focusing wheel | 9 Strap loop connector |
| 5 Diopter adjustment | |

Supplied with:
Functional side bag, cleaning cloth, soap, brush

The NL Pure is not supplied with the strap attached. The strap and other accessories are quick and easy to attach when required.

2. ATTACHING THE STRAP

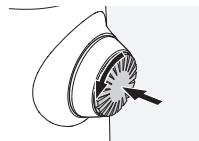

Press on the knob and rotate it counter-clockwise (90°).

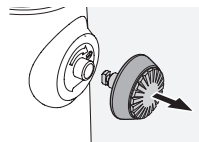

Pull the knob out.

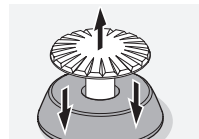

Remove the pin from the ring.

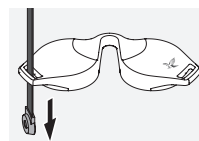

If you want to fit a rainguard or other accessory, pull the strap through the eyelet of the cover.

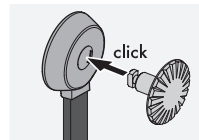

Then press the pin into the strap until it clicks.

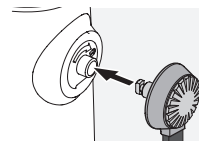

Insert the knob in the designated place on the binoculars.

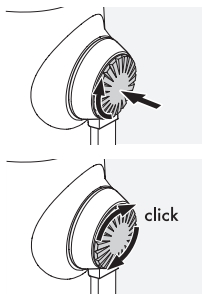

Push the knob in firmly and rotate slightly clockwise.

Release the pressure from the pin and continue to turn it clockwise until it clicks.

Note:

The pin is securely in place once you can no longer turn it without pressure.

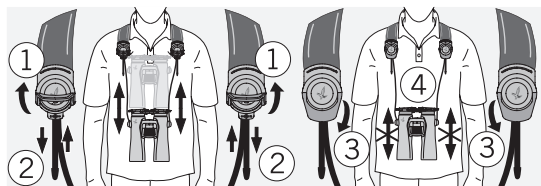
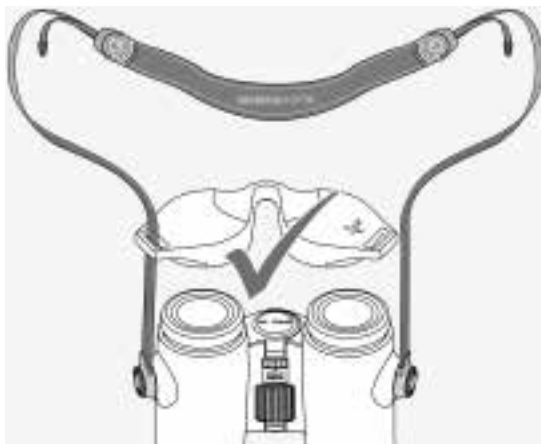

3. OPERATION

3.1 ADJUSTING THE TWIST-IN EYECUP

There are different setting positions to choose from, offering a different distance from the eye to the eyepiece lens. This allows you to adjust the eyecups separately to the position that suits you.

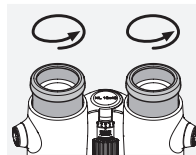

Pos. A: Starting position without spectacles: Turn the eyecups counter-clockwise to the full extent.

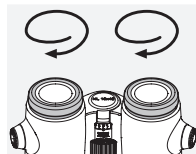

Pos. B: Starting position with spectacles: Turn the eyecups clockwise as far as they will go.

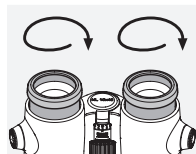

Pos. C and D: There are two alternative intermediate stages for observing with and without spectacles.

3.2 ADJUSTING THE DISTANCE BETWEEN THE EYEPIECES

To see a single round image, adjust the two halves of the binoculars until no irritating shadows can be seen.

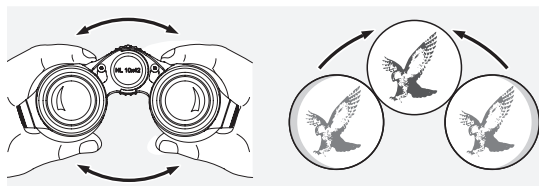

3.3 DIOPTER ADJUSTMENT

To ensure optimum image quality, adjust the focus to compensate for any differences between your left and right eye.

How to adjust if both eyes have equal vision

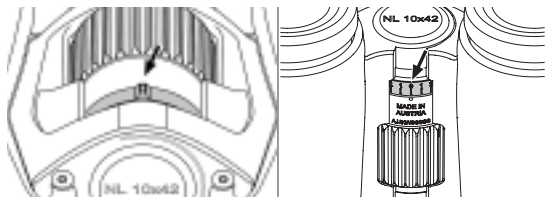

If you can see equally well with both eyes, make sure the diopter adjustment is set to zero. You can feel the protrusion on the adjusting ring engage in the zero position and the scale on the back of the binoculars corresponds to the index.

How to adjust if your eyes are different strengths

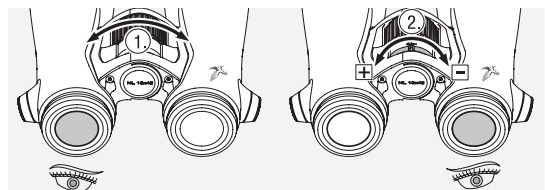

Look through the left eyepiece with your left eye. Select an object and rotate the focusing wheel until it is sharply focused. Now look at the same object through the right eyepiece with your right eye and adjust the diopter adjustment wheel until it is sharp.

3.4 ADJUSTING THE FOCUS

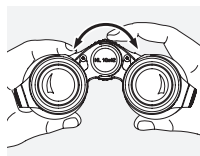

Turning the focusing wheel allows you to focus on any object from the shortest focusing distance (see technical data sheet) to infinity.

4. REMOVING THE OBJECTIVE LENS COVER

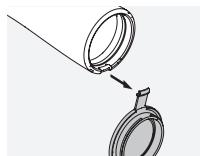

1. Open the objective lens cover.
2. Pull the lens cover firmly downwards.

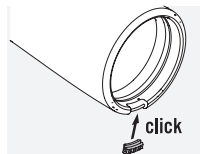

3. Fit the filler piece into the metal ring. When you hear a click, this means that it is attached.

Note:

When you want to replace the lens cover, slide the filler piece out of the metal ring with your thumb and then repeat Step 3 with the lens covers.

5. GENERAL INFORMATION

5.1 SERIAL NUMBER

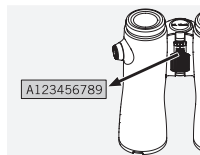

You will find the serial number of your NL Pure binoculars on the back under the diopter adjustment.

5.2 ADDITIONAL INFORMATION



For more details and tips visit:
SWAROVSKI OPTIK.COM.

6. CARE AND MAINTENANCE

6.1 LENS-CLEANING CLOTH

With the included microfiber lens-cleaning cloth you can clean even the most sensitive glass surfaces. It is ideal for objective lenses, eyepieces, and eyeglasses. Please keep the cloth clean, as dirt can damage the lens surface. Simply wash it in lukewarm soapy water and leave to air dry. Please only use it for cleaning glass surfaces.

6.2 CLEANING

We attach great importance to ensuring all elements and surfaces are very easy to clean.

Cleaning the optics. To ensure the long-lasting optical brilliance of your binoculars, you should keep the glass surfaces free from dirt, oil, and grease. First brush off any larger particles of dirt with an optical lens brush. Then breathe gently on the lens and polish it with the cleaning cloth to remove any remaining dirt. If it is very dirty (e.g. with sand), the twist-in eyecups can be completely unscrewed, making it very easy to clean.

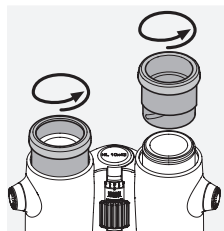

Cleaning the protective housing. Use the soap & brush kit (supplied). Close the covers on the eyepiece and objective lenses. Moisten the brush and apply the soap using circular movements to gently clean the housing. Rinse the binoculars with clean water and dry with care. If the optics become wet, dab them dry with a clean cloth to prevent scratching. Rinse the brush thoroughly and leave the soap & brush kit to dry.

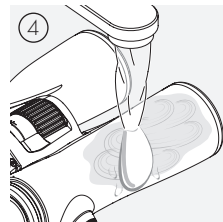
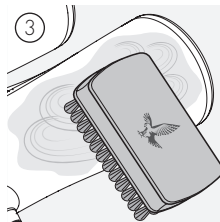
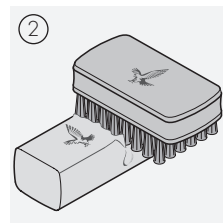
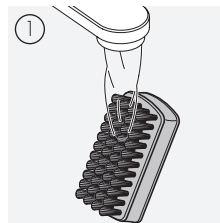

Note:

If you clean your binoculars outdoors, please ensure the soapy water does not contaminate the natural water cycle.

6.3 STORAGE

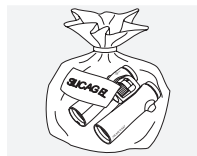

Keep your binoculars in their bag in a well-ventilated place. If the binoculars are wet, they must be dried first.

In tropical areas or areas with high humidity, it is best to store them in an airtight container with a moisture-absorbing agent (e.g. silica gel).

7. SAFETY RECOMMENDATIONS



Never look directly at the sun through the device as this could seriously damage your eyes.



Never look through the device while walking as you may overlook obstacles.

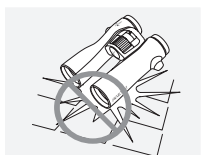

Protect your device against knocks.

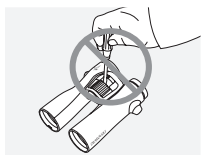

Repairs and servicing must only be carried out by SWAROVSKI OPTIK Absam (Austria) or SWAROVSKI OPTIK North America, otherwise your warranty will be void.

All the specifications given are typical values.

We reserve the right to make changes regarding design and delivery.
We accept no liability for printing errors.

MERCI D'AVOIR CHOISI
CE PRODUIT DE LA
MAISON SWAROVSKI
OPTIK. POUR TOUTE
QUESTION ADRESSEZ-VOUS
A VOTRE DETAILLANT
OU CONTACTEZ-NOUS
DIRECTEMENT SUR
SWAROVSKIOPTIK.COM.